

For additional information or copies of your service manual, please visit us online at:

[binks.com/en/library](https://binks.com/en/library)

Or use this QR code with your mobile device:

## **SG-2 PLUS™ 2 QT. PRESSURE CUPS**



Obey local or municipal regulations for product recycling and disposal.

**02 CONTENTS**

<b>03 SAFETY</b>	<b>1-4</b>
03.1 SAFETY PRECAUTIONS AND HAZARDS .....	1
03.2 ADDITIONAL SAFETY INFORMATION .....	4
<b>04 PRODUCT OVERVIEW</b>	<b>5-13</b>
04.1 SPECIFICATIONS .....	5
04.2 SETUP AND OPERATION .....	6
04.3 TYPICAL INSTALLATION .....	6
04.4 SPRAY TECHNIQUE .....	7
04.5 PARTS LIST – 80-600 SG-2 PLUSTM PRESSURE CUP (STANDARD) .....	8
04.6 PARTS LIST – 80-601 SG-2 PLUSTM PRESSURE CUP WITH OSCILLATING AGITATOR .....	10
04.7 ACCESSORIES FOR SG-2 PLUSTM PRESSURE CUPS (80-600 & 80-601) .....	12
04.8 OSCILLATING AGITATOR REPAIR KIT .....	12
04.9 PRESSURE CONVERSION KIT .....	13
<b>05 MANUAL REVISIONS</b>	<b>14</b>
<b>06 WARRANTY POLICY</b>	<b>15</b>

This page intentionally left blank.

## 03 SAFETY

### 03.1 SAFETY PRECAUTIONS

Before the operation, maintenance, or servicing of this Binks system; fully read and understand all technical and safety literature for your product. This manual contains information that is important for you to know and understand.

**This information relates to USER SAFETY and the PREVENTION OF EQUIPMENT PROBLEMS.**

To help you understand this information, we use recognizable ANSI Z535 and ISO warning boxes and symbols throughout this manual. Please obey these safety sections.

#### **⚠ DANGER**

**DANGER!** Indicates a hazardous situation that, if not avoided, will result in death or severe injury.

#### **⚠ WARNING**

**WARNING!** Indicates a hazardous situation that, if not avoided, could result in death or severe injury.

#### **⚠ CAUTION**

**Caution!** Indicates a hazardous situation that, if not avoided, could result in minor or moderate injury, or equipment damage.

#### **NOTICE**

**Notice:** Indicates information considered important but not hazard related.

#### **SAFETY**

**Safety:** Indicates a type of safety instruction, or a separate panel on a safety placard, where specific safety-related instructions or procedures are described.

Careful study and continued use of this manual will provide a better understanding of the equipment functions and procedures.

This understanding will result in improved operation, efficiency, and longer, trouble-free service with faster and easier troubleshooting. If you need the necessary safety literature for your specific system, contact your local Binks representative or Binks directly.

#### **NOTICE**

This manual lists standard specifications and service procedures. Differences can occur between this literature and your equipment.

Differences in local or municipal codes, manufacturer or plant requirements, material delivery requirements, and more can make variations unpreventable. To find these differences, compare this manual to your system installation drawings and other applicable Binks equipment manuals.

#### **⚠ WARNING**

The user **MUST** read and be familiar with the Safety Section in this manual and the safety literature therein identified.

Only trained personnel can operate this equipment.



All personnel who operate, clean, or maintain this equipment **MUST** fully read and understand this manual! To operate and service the equipment, follow all **WARNINGS** and safety requirements.







The user must be aware of and adhere to **ALL** local building and fire codes and ordinances, as well as **NFPA 33 AND EN 16985 SAFETY STANDARDS, LATEST EDITION**, or applicable country safety standards, before the installation, operation, or servicing of this equipment.

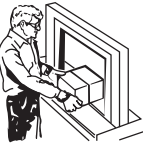



#### **⚠ WARNING**

The hazards shown on the pages that follow can occur during the normal use of this Binks equipment, but not all listed hazards will be applicable to your product model or equipment.

**Repairs may only be performed by personnel authorized by Binks.**

<b>AREAS</b> Indicate possible hazard occurrences.	<b>HAZARDS</b> Indicate possible hazards.	<b>SAFEGUARDS</b> Prevention of possible hazards.
	<b>Read the Manual</b>	Before operating finishing equipment, read and understand all safety, operation and maintenance information provided in the operation manual.
	<b>Operator Training</b>	All personnel must be trained before operating finishing equipment.
	<b>Equipment Misuse Hazard</b>	Equipment misuse can cause the equipment to rupture, malfunction, or start unexpectedly and result in serious injury.
	<b>Lock Out / Tag-Out</b>	Failure to de-energize, disconnect and lock out all power supplies before performing equipment maintenance could cause serious injury or death.
	<b>Automatic Equipment</b>	Automatic equipment may start suddenly without warning.
	<b>Pressure Relief Procedure</b>	Always follow the pressure relief procedure in the equipment instruction manual.
	<b>Keep Equipment Guards in Place</b>	Do not operate the equipment if the safety devices have been removed.
	<b>Know Where and How to Shut Off the Equipment in Case of an Emergency</b>	

<b>AREAS</b> Indicate possible hazard occurrences.	<b>HAZARDS</b> Indicate possible hazards.	<b>SAFEGUARDS</b> Prevention of possible hazards.
	<b>Wear Safety Glasses</b>	Failure to wear safety glasses with side shields could result in serious eye injury or blindness.
	<b>Inspect the Equipment Daily</b>	Inspect the equipment for worn or broken parts on a daily basis. Do not operate the equipment if you are uncertain about its condition.
	<b>Never Modify the Equipment</b>	Do not modify the equipment unless the manufacturer provides written approval.
	<b>Noise Hazard</b>	You may be injured by loud noise. Hearing protection may be required when using this equipment.
	<b>Projectile Hazard</b>	You may be injured by venting liquids or gases that are released under pressure, or flying debris.
	<b>Pinch Point Hazard</b>	Moving parts can crush and cut. Pinch points are basically any areas where there are moving parts.
	<b>Static Charge</b>	Fluid may develop a static charge that must be dissipated through proper grounding of the equipment, objects to be sprayed and all other electrically conductive objects in the dispensing area. Improper grounding or sparks can cause a hazardous condition and result in fire, explosion or electric shock and other serious injury.
	<b>Wear Respirator</b>	Toxic fumes can cause serious injury or death if inhaled. Wear a respirator as recommended by the fluid and solvent manufacturer's Safety Data Sheet.

<b>AREAS</b> Indicate possible hazard occurrences.	<b>HAZARDS</b> Indicate possible hazards.	<b>SAFEGUARDS</b> Prevention of possible hazards.
	<b>Toxic Fluid &amp; Fumes</b>	Hazardous fluid or toxic fumes can cause serious injury or death if splashed in the eyes or on the skin, inhaled, injected or swallowed. LEARN and KNOW the specific hazards or the fluids you are using.
	<b>Fire and Explosion Hazard</b>	Improper equipment grounding, poor ventilation, open flame or sparks can cause a hazardous condition and result in fire or explosion and serious injury.
	<b>Medical Alert</b>	Any injury caused by high pressure liquid can be serious. If you are injured or even suspect an injury: <ul style="list-style-type: none"> <li>• Go to an emergency room immediately.</li> <li>• Tell the doctor you suspect an injection injury.</li> <li>• Show the doctor this medical information or the medical alert card provided with your airless spray equipment.</li> <li>• Tell the doctor what kind of fluid you were spraying or dispensing.</li> </ul>
	<b>Get Immediate Medical Attention</b>	To prevent contact with the fluid, please note the following: <ul style="list-style-type: none"> <li>• Never point the gun/valve at anyone or any part of the body.</li> <li>• Never put hand or fingers over the spray tip.</li> <li>• Never attempt to stop or deflect fluid leaks with your hand, body, glove or rag.</li> <li>• Always have the tip guard on the spray gun before spraying.</li> <li>• Always ensure that the gun trigger safety operates before spraying.</li> </ul>

### 03.2 ADDITIONAL SAFETY INFORMATION

Observe all local or municipal safety measures and wear approved protective equipment when servicing this equipment. Clean all spilled chemicals and materials and do all work in a clean and organized environment to prevent personal injury and equipment damage.

## 04 PRODUCT OVERVIEW

### SG-2 PLUSTM 2 QT. PRESSURE CUPS

**MODEL NO. 80-600 (STANDARD)**

**MODEL NO. 80-601 (WITH OSCILLATING AGITATOR)**

The Binks SG-2 Plus™ Pressure Cup is ideal for component spraying and industrial applications where small batch production spraying is required. The 2 qt. capacity is sufficient to complete large spray jobs without refilling the cup. Its lightweight and rugged construction is excellent for portability allowing the operator to make fluid and air control adjustments quickly and efficiently at the spray station.

The internal construction is designed for waterborne and solvent base materials.

Other features include:

- Stainless steel pick-up tube, fluid fittings and removable plastic liner makes it corrosion resistant.
- “Wide-mouth” opening allows easy cleaning, plastic liner removal and quick color change.
- Positive grip carrying handle for operator comfort.
- Wide stainless steel base for stability and corrosion resistance.
- 0-10 psig fluid pressure range.
- Optional 0-50 psig pressure kit (80-619) available for high viscosity fluids.
- Fluid agitator on model 80-601 for paints requiring continuous agitation.
- Silverstone® coating on interior and exterior of lid.

### 04.1 SPECIFICATIONS

Max. Working Pressure	50 psig	3.5 KG/cm <sup>2</sup>
Overall Height	15 11/16 in.	39.88 cm
Base Diameter	6 in.	15.24 cm
Diameter Across Closed Clamps	8 1/16 in.	20.47 cm
Diameter Across Open Clamps	8 1/16 in.	20.47 cm
Air Inlet & Outlet Connection Size	1/4 NPS (m)	—
Fluid Outlet Connection Size	3/8 NPS (m)	—
Fluid Capacity	2 Qts. (U.S.)	1.9 Liters
Weight, Standard Unit	4 lb.14 oz.	2.21 kg.
Weight, Unit with Agitator	5 lb.7 oz.	2.47 kg.

## ! WARNING

All air and fluid pressure in the system must be relieved before servicing the cup and before cup is filled or cleaned. Attempting to service the cup while pressurized could result in damage to components or personal injury.

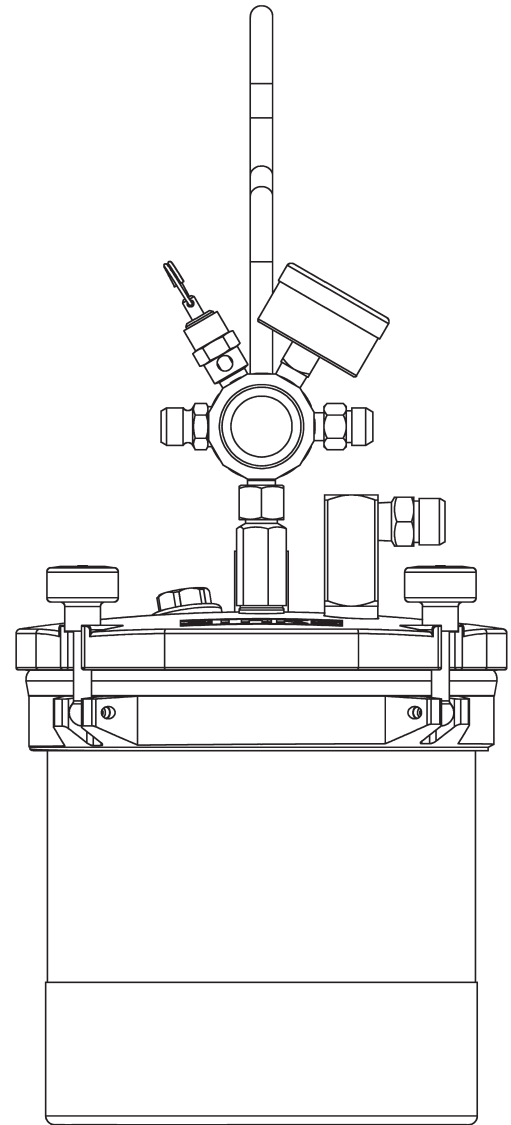

**MODEL NO. 80-600 (STANDARD)**

## 04.2 SETUP AND OPERATION

Refer to "TYPICAL INSTALLATION" drawing below

Set up the SG-2 Plus™ with the CONVENTIONAL or HVLP gun along with at least 5 ft. of air and fluid hose.

Attach air hose from extractor to air inlet on handle of steady-grip assembly. Pour paint into canister with liner. Re-attach lid to canister and firmly tighten four knobs over canister lid. Set air pressure from air regulator mounted on extractor and fluid pressure by adjusting fluid pressure adjustment knob on cup handle.

### ⚠ CAUTION

Do not exceed 100 PSIG input air pressure into the cup. Excessive pressure could damage components.

### ⚠ WARNING

Chlorinated solvents and aluminum are incompatible and will cause an adverse chemical reaction, possibly resulting in bodily injury. Under NO circumstances should chlorinated solvents be used with the "SG2 Plus" pressure cup with agitator (80-601). With the standard "SG2 Plus" pressure cup, use chlorinated solvents only when using plastic liner (80-356).

### NOTICE

Before refilling canister with paint, shut off air supply to the cup and release pressure from canister by rotating pressure relief knob counterclockwise.

## 04.3 TYPICAL INSTALLATION

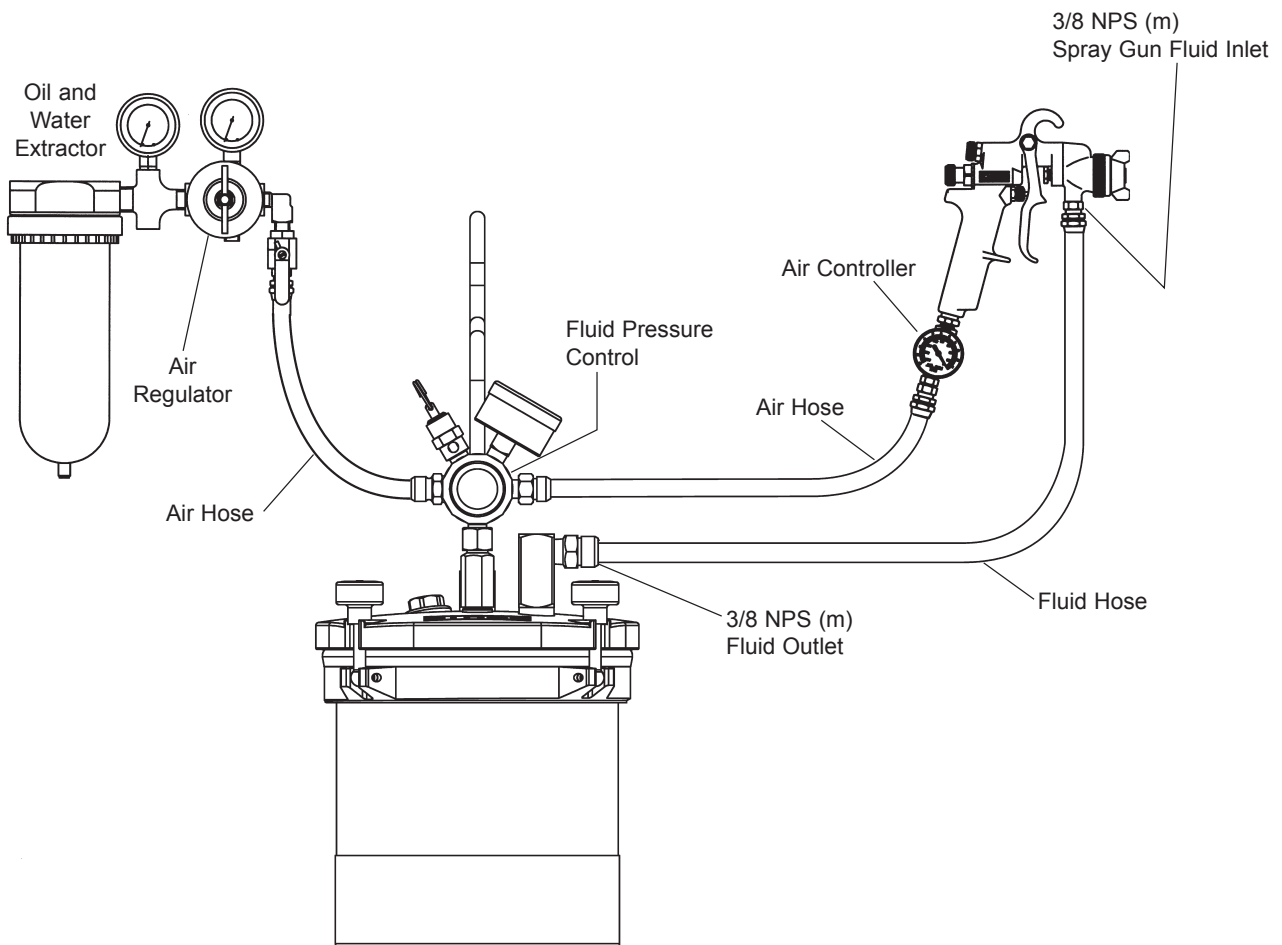

### 04.4 SPRAY TECHNIQUE

The first requirement for a good resultant finish is the proper handling of the gun. The gun should be held perpendicular to the surface being covered and moved parallel with it. The stroke should be started before the trigger is pulled, and the trigger should be released before the stroke is ended. This gives accurate control of the gun and material.

The distance between the gun and surface should be 6 to 10 inches depending on material and atomizing pressure. The material deposited should always be even and wet. Lap each stroke over the preceding stroke to obtain a uniform finish.

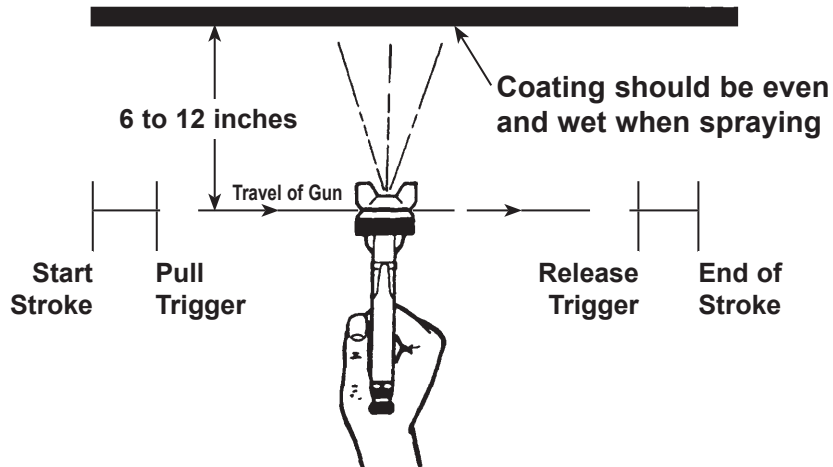

**CORRECT**

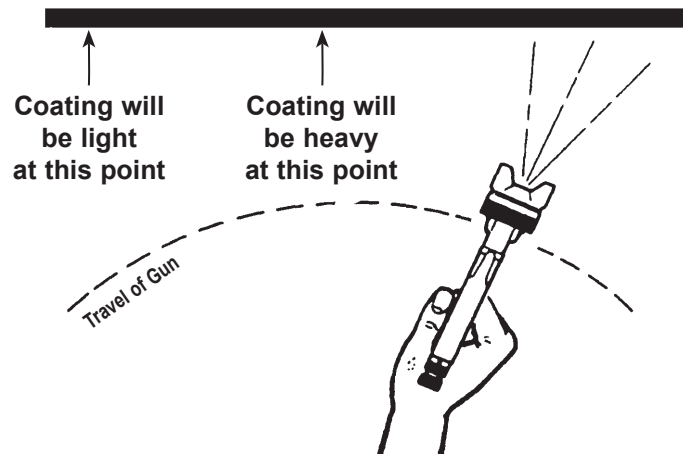

**INCORRECT**

04.5 PARTS LIST – 80-600 SG-2 PLUS™ PRESSURE CUP (STANDARD)

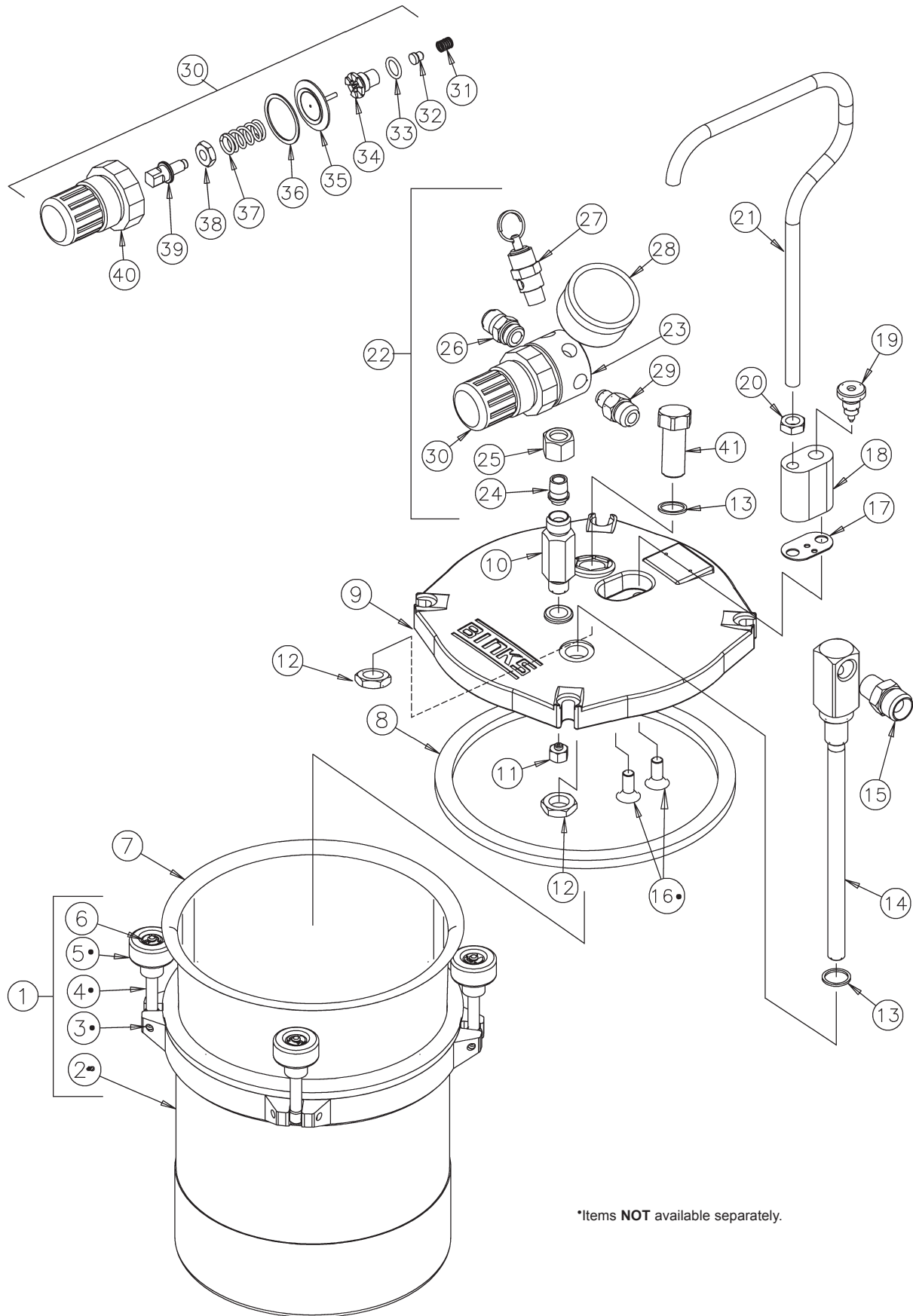

## 80-600 PARTS LIST

ITEM NO.	PART NO.	DESCRIPTION	QTY.	ITEM NO.	PART NO.	DESCRIPTION	QTY.
1	80-375	2 QT CANISTER ASM	1	24	72-104	TAIL PIECE	1
2	— +	2 QT CANISTER SUB-ASM	1	25	72-93	SWIVEL NUT, 1/4 NPS	1
3	— +○	SPIROL PIN	4	26	54-308	AIR CONNECTION	1
4	— +○	CANISTER KNOB SWIVEL	4	27	TIA-4326*	SAFETY VALVE	1
5	— +○	CANISTER KNOB	4	28	59-299	GAUGE, 15 PSI	1
6	80-382 +○	RETAINING RING	4	29	71-28	DM NIPPLE, 1/8 NPT X 1/4 NPS	1
7	80-355-72 ●	DISPOSABLE LINER	1	30	85-437*■	REGULATOR KIT, 15 PSI	2
8	80-392*	LID GASKET	1	31	— ◆□	VALVE SPRING	1
9	80-602	COVER MACHINING	1	32	— ◆□	VALVE, PTFE	1
10	80-606	CHECK VALVE ASM	1	33	— ◆□	O-RING	1
11	80-610	DIFFUSER	1	34	— ◆□	VALVE SEAT	1
12	80-389	FLUID TUBE NUT	2	35	— ◆□	DIAPHRAGM	1
13	80-388*	FLUID TUBE SEAL	2	36	— ◆□	VALVE SPRING	1
14	80-613	FLUID TUBE ASM	1	37	— ◆	REGULATING SPRING	1
15	83-2484	DM NIPPLE, 1/4 NPT X 3/8 NPS	1	38	— ◆	NUT	1
16	20-6582	SCREW	2	39	— ◆	STEM	1
17	80-373*	HANDLE GASKET	1	40	— ◆	BONNET	1
18	80-604	MANIFOLD	1	41	80-616	TOP OUTLET PLUG	1
19	80-12	RELIEF VALVE	1				
20	20-353-1	JAM NUT, 5/16-18	1				
21	80-605	HANDLE	1				
22	85-449	REGULATOR ASM (15# gauge)	1				
23	85-436	REGULATOR BODY	1				

\* Part of 80-617 Pressure Cup Repair Kit

+ Part of 80-375 2Qt Canister Assy.

○ Part of 80-390 Knob Replacement Kit

● Available only as a quantity pack (See Accessories, 80-356, below)

■ Used in 85-449 Regulator Assembly

◆ Part of 85-437 Regulator Kit (NOT available separately)

□ Part of KK-4887-2 Regulator Repair Kit

04.6 PARTS LIST – 80-601 SG-2 PLUS™ PRESSURE CUP WITH OSCILLATING AGITATOR

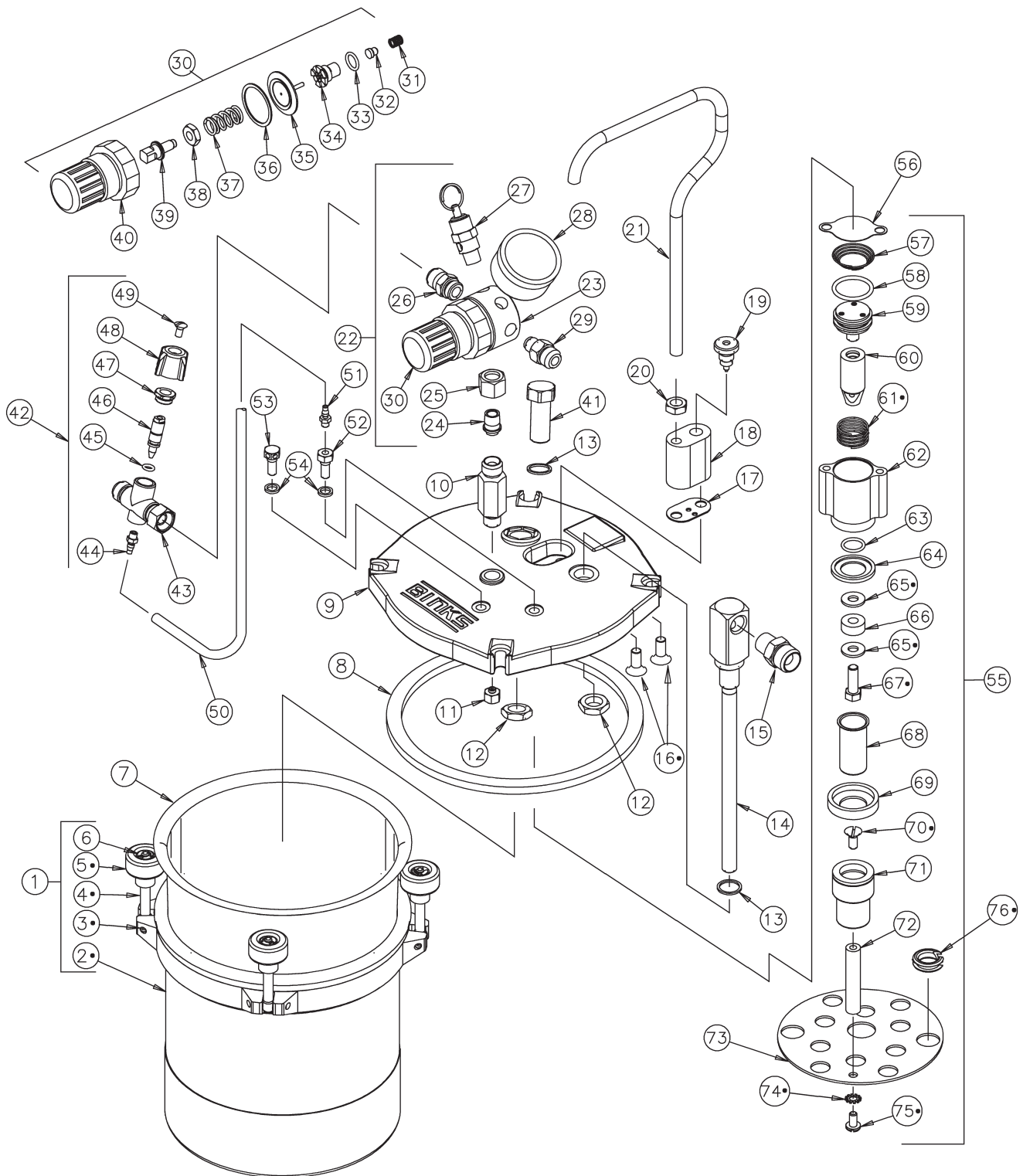

\*Items NOT available separately.

## 80-601 PARTS LIST

ITEM NO.	PART NO.	DESCRIPTION	QTY.	ITEM NO.	PART NO.	DESCRIPTION	QTY.
1	80-375	2 QT CANISTER ASM	1	36	— ◆□	VALVE SPRING	1
2	— +	2 QT CANISTER SUB-ASM	1	37	— ◆	REGULATING SPRING	1
3	— +○†	SPIROL PIN	4	38	— ◆	NUT	1
4	— +○†	CANISTER KNOB SWIVEL	4	39	— ◆	STEM	1
5	— +○†	CANISTER KNOB	4	40	— ◆	BONNET	1
6	80-382 +○	RETAINING RING	4	41	80-616	TOP OUTLET PLUG	1
7	80-355-72 •	DISPOSABLE LINER (See 80-356 in ACCESSORIES)	1	42	82-740	AIR CONTROL VALVE ASSEMBLY	1
8	80-392*	LID GASKET	1	43	— ■	VALVE BODY ASSEMBLY	1
9	—	COVER MACHINING	1	44	81-307 ■	BARBED CONNECTOR	1
10	80-606	CHECK VALVE ASM	1	45	20-3236-5 ■✱	O-RING	1
11	80-610	DIFFUSER	1	46	— ■	STEM	1
12	80-389	FLUID TUBE NUT	2	47	— ■	NUT	1
13	80-388*	FLUID TUBE SEAL	2	48	73-46 ■	CAP	1
14	80-613	FLUID TUBE ASM	1	49	20-2606-1 ■	SCREW 8-32 x 3/8" Oval Hd	1
15	83-2484	DM NIPPLE, 1/4 NPT X 3/8 NPS	1	50	54-3929-5	TUBE 6-1/2 " Nylon	1
16	20-6582 †	SCREW	2	51	81-307	BARBED CONNECTOR	1
17	80-373*	HANDLE GASKET	1	52	82-728	INLET FITTING	1
18	80-604	MANIFOLD	1	53	82-729	EXHAUST FITTING	1
19	80-12	RELIEF VALVE	1	54	82-730 ✱	GASKET	2
20	20-353-1	JAM NUT, 5/16-18	1	55	80-611	SG2 PLUS OSCILLATING AGITATOR ASSEMBLY	1
21	80-605	HANDLE	1	56	82-727 ✱	CYLINDER GASKET	1
22	85-449	REGULATOR ASM (15# gauge)	1	57	82-720 ✱	CONICAL SPRING	1
23	85-436	REGULATOR BODY	1	58	20-5845 ✱	O-RING	1
24	72-104	TAIL PIECE	1	59	82-714 ✱	PISTON ASSEMBLY	1
25	72-93	SWIVEL NUT, 1/4 NPS	1	60	82-779	PISTON ROD	1
26	54-308	AIR CONNECTION	1	61	82-721 ✱†	COMPRESSION SPRING	1
27	TIA-4326	SAFETY VALVE*	1	62	82-711	CYLINDER ASSEMBLY	1
28	59-299	GAUGE, 15 PSI	1	63	20-3753 ✱	O-RING	1
29	71-28	DM NIPPLE, 1/8 NPT X 1/4 NPS	1	64	82-776 ✱	CAN SEAL	1
30	85-437* ◇	REGULATOR KIT, 15 PSI	2	65	82-777	INNER RING	1
31	— ◆□	VALVE SPRING	1	66	82-753	INNER MAGNET	1
32	— ◆□	VALVE, PTFE	1	67	— †	SCREW 1/4-28 x 3/4" Hex Hd	1
33	— ◆□	O-RING	1	68	82-775 ✱	CAN	1
34	— ◆□	VALVE SEAT	1	69	82-778	CAN RETAINER	1
35	— ◆□	DIAPHRAGM	1	70	— †	SCREW 12-24 x 1/2" Flat Hd	1
				71	82-770	OUTER MAGNET ASSEMBLY	1
				72	80-406	OSCILLATING AGITATOR POST	1
				73	—	OSCILLATING AGITATOR PLATE	1
				74	20-2530†	#10 EXTERNAL STAR WASHER	1
				75	20-5832†	SCREW 10-32 x 3/8" Pan Hd	1
				76	— ✱†	GROMMET	1

\* Part of 80-617 Pressure Cup Repair Kit

+ Part of 80-375 2Qt Canister Assy.

○ Part of 80-390 Knob Replacement Kit

■ Part of 82-740 Air Control Valve Assembly

◇ Used in 85-449 Regulator Assembly

◆ Part of 85-437 Regulator Kit

□ Part of KK-4887-2 Regulator Repair Kit

✱ Part of 80-612 Oscillating Agitator Repair Kit

## 04.7 ACCESSORIES FOR SG-2 PLUS™ PRESSURE CUPS (80-600 &amp; 80-601)

**ACCESSORIES**

(NOT FURNISHED, PLEASE ORDER SEPARATELY.)

PART NO.	DESCRIPTION	QTY.
80-356	CANISTER LINER (QTY. PACK OF 80-355)	12/PK
85-441	IN-LINE REGULATOR ASSEMBLY (50 PSI)	1
HAV-500	AIR ADJUSTING VALVE	1
HAV-501	AIR ADJUSTING VALVE W/GAUGE	1

**BINKS STEADI-GRIP 2 OUTFIT****98-1263 MACH 1SL HVLP SPRAY GUN OUTFIT WITH STANDARD CUP CONSISTING OF:**

80-600	STEADI-GRIP 2 QT. PRESSURE POT (STD.)
HAV-501	AIR FLOW CONTROLLER, MOUNTED ON SPRAY GUN INLET
7000-1604-4	MACH 1SL SPRAY GUN WITH 92 FLUID NOZZLE AND 94P AIRCAP ASSEMBLY
71-1201	AIR HOSE, 1/4" X 5' LONG
71-3380	FLUID HOSE, 3/8" X 5' LONG

**80-617 PRESSURE CUP REPAIR KIT**

(LOW PRESSURE – 10# SPRING)

PART NO.	DESCRIPTION	QTY.
85-437	REGULATOR KIT, (10# SPRING)	1
80-373	HANDLE GASKET	1
80-388	FLUID TUBE SEAL	2
80-392	LID GASKET	1
TIA-4326	SAFETY VALVE	1

**80-619 HIGH PRESSURE CONVERSION KIT**

(SEE NEXT PAGE FOR DETAILS)

PART NO.	DESCRIPTION	QTY.
59-369	GAUGE, (60 PSI)	1
85-438	REGULATOR KIT, (50# SPRING)	1
85-243	SAFETY VALVE	1

## 04.8 OSCILLATING AGITATOR REPAIR KIT

**80-612 OSCILLATING AGITATOR REPAIR KIT**

(FOR MODEL 80-601)

PART NO.	DESCRIPTION	QTY.	PART NO.	DESCRIPTION	QTY.
20-3236-5*	O-RING	1	20-3753	O-RING	1
82-730	GASKET	2	82-776	CAN SEAL	1
82-727	CYLINDER GASKET	1	82-775	CAN	1
82-720	CONICAL SPRING	1	— †	GROMMET	1
20-5845	O-RING	1	82-714	PISTON ASSEMBLY	1
82-721 †	SPRING	1			

\* Available only as a quantity pack. † Items NOT available separately.

**04.9 PRESSURE CONVERSION KIT**

**CONVERSION KIT 80-619**

Allows conversion from low (0-10 PSI) to high pressure operation.

**! WARNING**

Attempting to install the conversion kit while the system is pressurized could result in damage to components or bodily injury.

**INSTRUCTIONS**

1. Depressurize and shut off the entire system before installing the conversion kit.
2. Remove regulator from cup.
3. Replace gauge with gauge provided in the conversion kit.
4. Replace the regulating spring.
5. Inspect all other internal components of the regulator and replace with new items from the conversion kit as needed and reassemble the regulator.
6. Reassemble the regulator to the cup.

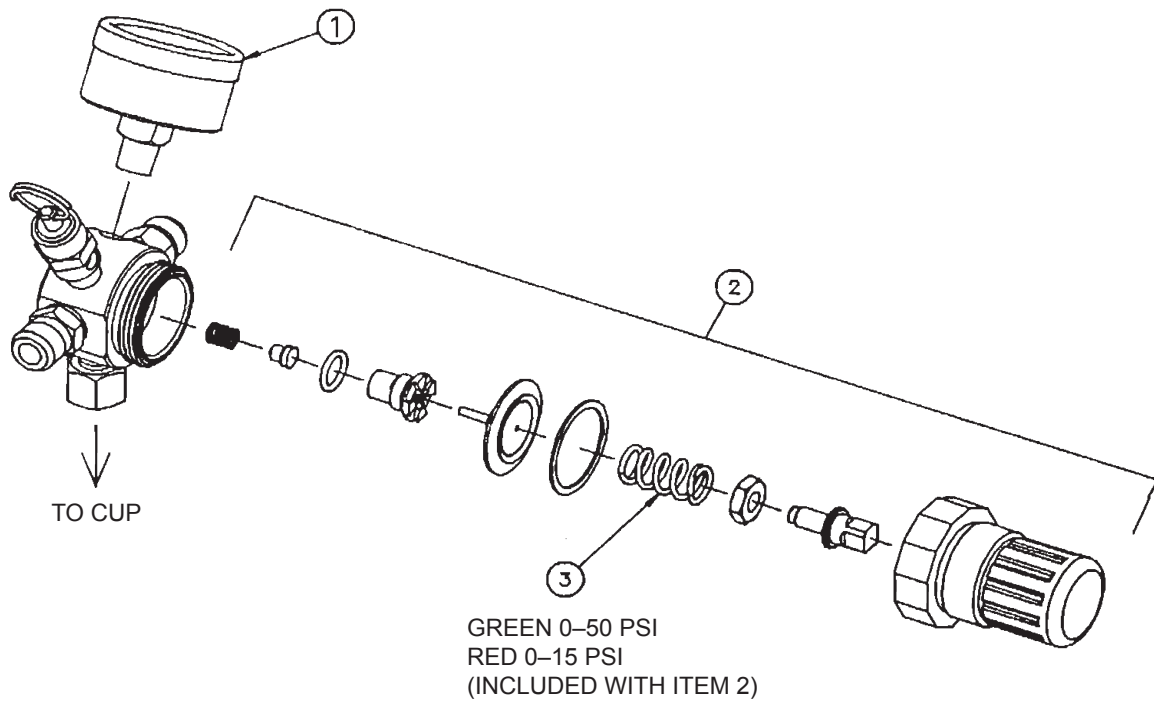

**80-619 PARTS LIST**

CONVERSION KIT (REF)	HOW USED	ITEM 1 GAUGE	ITEM 2 REGULATOR KIT	ITEM 3 SPRING
80-619	CONVERT TO HIGH PRESSURE	59-369 (0-60 PSI)	85-438	GREEN (0-50 PSI)
—	CONVERT TO LOW PRESSURE	59-299 (0-15 PSI)	85-437	RED (0-15 PSI)

**MANUAL CHANGE SUMMARY**

Date	Description	Version
08/15/2025	Revised Safety section	R10
05/12/2025	Rebranded to Binks	R9

## WARRANTY POLICY

This product is covered by Binks' materials and workmanship limited warranty.

The use of parts or accessories from sources other than Binks will void all warranties. Failure to follow reasonable maintenance guidance provided can invalidate the warranty.

For specific warranty information, please contact Binks.

---

For technical assistance or to locate an authorized distributor, contact one of our international sales and customer support locations listed below.

REGION	BINKS CONTACT
Americas	Tel: 1-800-992-4657
Europe, Africa, Middle East	Tel: +4401202571111
India	marketingroa@binks.com
China	Tel: +862133730108
Korea	Tel: +82313663303
Japan	Tel: +81457856421
Australia	Tel: +61085257555

## WARRANTY PAGE

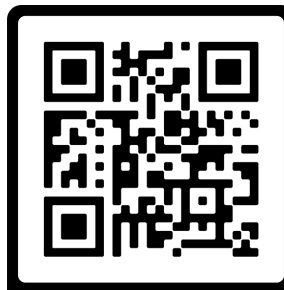

# Binks<sup>®</sup>

Binks is a global leader in innovative finishing technologies.  
Binks reserves the right to modify equipment specifications without prior notice.  
Binks<sup>®</sup>, DeVilbiss<sup>®</sup> and Ransburg<sup>®</sup> are registered trademarks of Binks US, LLC.