

BINKS MX 35/36, 30/42, 35/60, 30/70

Airless and Air Assisted Airless Spraying Outfits

Binks MX35/36, MX30/42, MX35/60 and MX30/70 Airless and AAA pumps have the pumping power and fluid delivery capacity for all those heavy duty applications.



Binks MX pumps are a completely new design in air operated pump technology utilising patented magnetic detents to dramatically enhance smooth pump operation and change over with virtually no pulse to provide the best "surge free" paint delivery for the perfect finish.

These MX pumps operate at ratios of 70:1, 60:1, 42:1 and 36:1, delivering up to a massive output of 11.4 or 13.2 litres per minute at 60 cycles (max). They are fitted with Ceramic-Coated pistons and self adjusting spring loaded packings to extend their working life and reduce the need for costly maintenance and downtime.

Binks MX pump pistons are Ceramic-Coated which lasts up to 3 times longer than hard chrome to further extend the pump working life cycle. The fluid sections and all wetted parts are constructed from high grade carbon or stainless steel with tungsten carbide seats for durability and best paint compatibility.

MX Cart and Wall outfits include a St. St. fluid filter, air filter/regulator controls and suction wand as standard.

5 Year pump warranty on materials and workmanship

Anti-Stall Magnetic detents (patent) with quick exhaust valves for fast stroke change over with virtually no pulse

Carbon or Stainless Steel wetted parts with Ceramic-Coated piston rod for extended working life cycle

Quiet Operation, No Ice, Air Motor is also lubrication free

Self adjusting spring loaded packing's with large lubricant cup for reduced down time

Quick disconnect fluid section from air motor for easier servicing

CE marked and fully ATEX approved

Typical Applications

- Corrosion protection applications
- Large steel fabrications and structures
- Gas and Oil installations
- Marine and Ship Building
- Skips and Dumpsters
- Off Road Vehicles
- Truck/Bus/Trailer and Chassis makers
- Plus many others...

Suitable for these paint materials

- Solvent OR Waterborne coatings
- Zinc rich primers and paints
- Cold Tar Epoxies
- Heavily bodies Urethanes
- Enamels and Polyurethane's
- Plus many others...

BINKS MX

finishingbrands.eu



Stainless Steel Pumps offer protection from corrosion when pumping today's preferred waterborne coatings. In addition, they offer the greatest future versatility for new coatings formulated due to regulation changes or enhanced production requirements.

Binks MX pump pistons are Ceramic-Coated – which is the most durable surface available. Resisting wear from highly abrasive fluids whilst reducing friction. Binks Ceramic-Coating is the ultimate choice for sliding components in pumps. More information on the benefits and advantages of Binks Ceramic Coating is available upon request.

Carbon Steel Pumps have a limited role on solvent-based applications and are not suitable for waterborne applications.

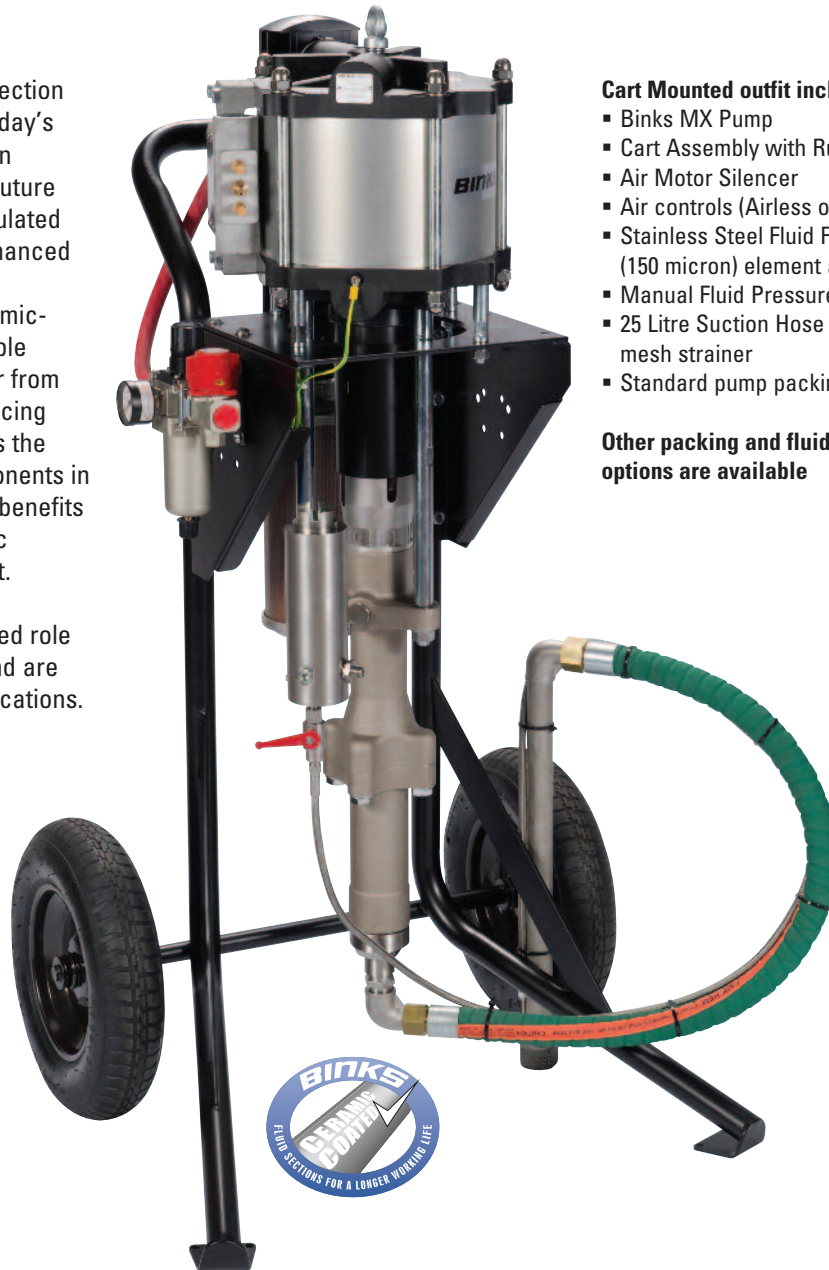

Cart Mounted outfit includes:-

- Binks MX Pump
- Cart Assembly with Run Flat Tyres
- Air Motor Silencer
- Air controls (Airless or Air Assisted)
- Stainless Steel Fluid Filter with 100 mesh (150 micron) element as standard
- Manual Fluid Pressure Relief Valve
- 25 Litre Suction Hose Assembly with 30 mesh strainer
- Standard pump packing's PTFE/UHMWPE.

Other packing and fluid filter mesh size options are available

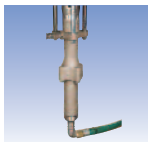

Stainless Steel fluid sections supplied as standard. Carbon steel is optional.



30 mesh stainless steel strainer fitted on suction wand as standard.



H.P. stainless steel fluid filter with dump valve for up to two gun outlets supplied as standard.



Binks MX carts feature solid, run flat tyres for easy transportation around site.

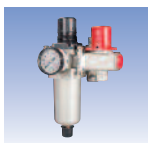

Air filter regulator assembly for Airless OR Air assisted airless operation is included.

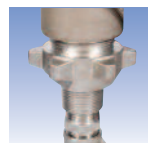

Optional "knock-off" fluid inlet is available for faster pump disassembly in the field.

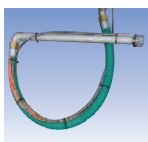

25 litre Suction Hose with wall and cart mounted pump packages.



Optional hose storage bracket for cart and wall outfits.

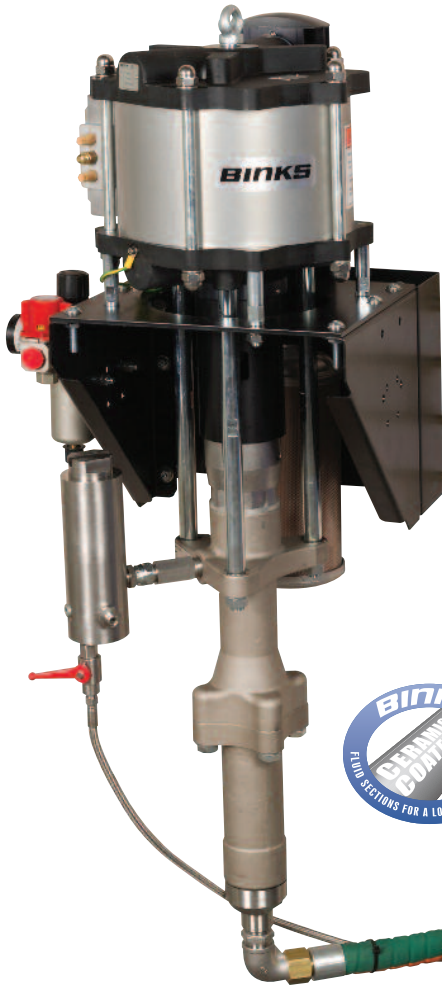

Wall Mounted outfit includes:-

- Binks MX Pump
- Wall mounting bracket
- Air Motor Silencer
- Air controls (Airless or Air Assisted)
- Stainless Steel Fluid Filter with 100mesh (150 micron) element as standard
- Manual Fluid Pressure Relief Valve
- 25 Litre Suction Hose Assembly
- Standard pump packing's PTFE/UHMWPE.

Other packing and fluid filter mesh size options are available



Binks MX outfits are fully complete EXCLUDING guns and HP hoses. Guns, HP Hoses and accessories can be added to the MX outfits as an extra part number on the order to complete the package for any kind of application.



Binks Airless A75 gun operates up to 7500psi (571BAR).



Binks AA4400M gun for Air Assisted Airless applications.

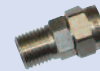

72-2332 – Binks Micro-Swivel 1/4 NPS (F) to 1/4 NPS (M) for extra gun manoeuvrability.



Binks full range of accessories include; HP (500 BAR) airless hoses, whip ends. Gun micro-swivels and connectors to join HP hoses.

For the full range of Binks accessories see the back page.



BINKS MX Pump Outfit contents and part numbers

	MX22036PU-SAH-CAL	MX22036PU-SAH-WAL	MX22036PU-SAH-CAC	MX22036PU-SAH-WAC	MX19042PU-SAH-CAL	MX19042PU-SAH-WAL	MX22060PU-SAH-CAL	MX22060PU-SAH-WAL	MX19070PU-SAH-CAL	MX19070PU-SAH-WAL
Bare Pump MX 35/36 (36:1 ratio / 220 cc/cycle)	■	■	■	■						
Bare Pump MX 30/42 (42:1 ratio / 190 cc/cycle)					■	■				
Bare Pump MX 35/60 (60:1 ratio / 220 cc/cycle)							■	■		
Bare Pump MX 30/70 (70:1 ratio / 190 cc/cycle)									■	■
High Pressure Stainless Steel Filter	■	■	■	■	■	■	■	■	■	■
Cart Mounted	■		■		■		■		■	
Wall Mounted				■		■		■		■
Airless Controls	■	■			■	■	■	■	■	■
Air Assisted Airless Controls			■	■						
Flexible suction hose assembly with 30 MESH strainer	■	■	■	■	■	■	■	■	■	■

Ordering example: MX22060PU-SAH-CAL = MX35/60 Cart Mounted Airless Outfit (excluding gun and hoses)

MX22060PU-SAH-CAL

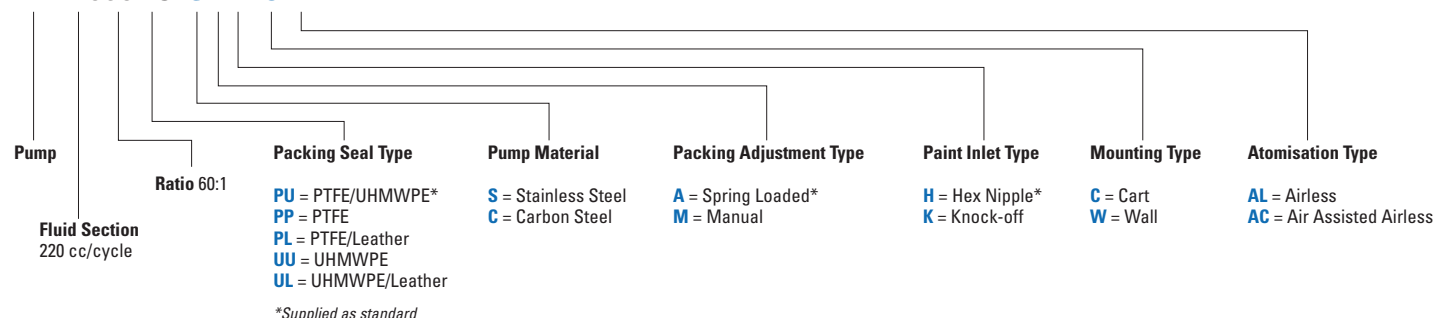



Binks MX accessories and spares	Part No.
Binks Airless 75 hand gun with st st fluid tube	0811-7500-1
Binks Airless 75 hand gun with direct connect connector	0811-7500-2
Binks AA4400M AAA spray gun AA10 cap (tip) with 7.5M hose assembly	AA4400M-75
Cart assembly for MX35/36 & MX30/42	104136
Cart assembly for MX35/60 & MX30/70	104084
Wall Bracket assembly for MX35/36 & MX30/42	104116
Wall Bracket assembly for MX35/60 & MX30/70	104095
Silencer	0115-010443
Air Control regulator / filter (Airless)	MXA-C13ALM5-H34
Air Controls regulator / filter (Air Assisted Airless)	MXA-C13ACM5-H34
St St H.P. Type 11 Fluid Filter assembly	0114-011760
25 litre suction hose assembly, including 30 mesh strainer, dump hose & 1/4" connector	MXA-S25ME30-DH114
210 litre suction hose assembly, including 30 mesh strainer, dump hose & 1/4" connector	MXA-S210ME30-DH114
1.8 M Airless whip end 1/4" bore with 1/4" NPS conns (500BAR)	H-5850
1 M Airless whip end 3/16" bore with 1/4" NPS conns (500BAR)	H-5851
15 M Airless hose assembly 1/4" bore with 1/4" NPS conns (500BAR)	H-5852
15M Airless Hose assembly 3/8" bore with 3/8" NPS conns (500BAR)	H-5853
1/4" x 1/4" D.M nipple to join 2 x 1/4" NPT Airless hoses	74-011/1
1/4" to 3/8" D.M nipple to join 1/4" NPT and 3/8" NPT Airless hoses	74-012/1
Binks Micro-Swivel 1/4" NPS (F) to 1/4" NPS (M) (550BAR)	72-2332
Binks Micro-Swivel 3/8" NPS (F) to 1/4" NPS (M) (550BAR)	72-2333
Optional hose storage bracket for cart and wall assembly	193381

Binks MX stainless steel pump pistons are Ceramic-Coated which is the most durable surface available for resisting wear from highly abrasive fluids, whilst reducing friction and extending the pump packing life cycle. Binks Ceramic-Coating is the ultimate choice for sliding components in pumps. More information on the benefits and advantages of Binks Ceramic-Coating is available upon request.



H.P. Filter elements:	Part No.
30 mesh	0114-014917
50 mesh	0114-014886
70 mesh	0114-014884
100 mesh	0114-014883
150 mesh	0114-014882
200 mesh	0114-014881
Air Motor Spares kits:	Part No.
MX 35/36 Air Motor Spares kit	250703
MX 30/42 Air Motor Spares kit	250703
MX 35/60 Air Motor Spares kit	250645
MX 30/70 Air Motor Spares kit	250645
Fluid section (PU) seal kits:	Part No.
MX 35/36 Fluid section seal kit	250659
MX 30/42 Fluid section seal kit	250663
MX 35/60 Fluid section seal kit	250659
MX 30/70 Fluid section seal kit	250663



MX35/60 outfit with A75 gun and hoses and optional bracket for storing hoses and gun.

Pump Specification	MX 35/36	MX 30/42	MX 35/60	MX 30/70
Ratio	36:1	42:1	60:1	70:1
Max. Inlet Pressure	8.0 bar (116 psi)	7.0 bar (101.5 psi)	8.0 bar (116 psi)	7.0 bar (101.5 psi)
Flow Rate @ 15 cycles (continuous)	3.3 l/min	2.85 l/min	3.3 l/min	2.85 l/min
Flow Rate @ 30 cycles (intermittent)	6.6 l/min	5.7 l/min	6.6 l/min	5.7 l/min
Volume/Cycle	220 ml	190 ml	220 ml	190 ml
Max. Fluid Pressure	288 bar (4176 psi)	294 bar (4263 psi)	480 bar (6960 psi)	490 bar (7105 psi)
Cylinder Diameter	200 mm	200 mm	260 mm	260 mm
Piston Stroke	127 mm	127 mm	127 mm	127 mm
Noise Level	*82.9dB(A)	*82.9dB(A)	*80.7dB(A)	*80.7dB(A)
Air Consumption @ 20 cycles/min	1132 l/min (40 SCFM)	1132 l/min (40 SCFM)	1985 l/min (70.1 SCFM)	1792 l/min (63.3 SCFM)

*Noise level recorded in free field conditions whilst pump was running at 100psi (7 BAR) @ 30 cycles per minute.

**BINKS MX SERIES
5-YEAR WARRANTY**

Binks® warrants to the original end-use purchaser that the Binks branded products "MX" shall not fail under normal use and service due to a defect in material or workmanship within five (5) years from the date of shipment from Binks. Does not include normal wear and tear parts.



For more technical information refer to the Service Bulletin

**Sales and Service through our
Global Network of Industrial Distributors**

Finishing Brands Locations

- Americas: **USA** ▪ **Mexico** ▪ **Brazil**
- Europe/Asia/Africa: **United Kingdom** ▪ **France** ▪ **Germany**
- Pacific Rim: **China** ▪ **Japan** ▪ **Australia**



www.finishingbrands.eu

email: marketing@finishingbrands.eu

